



Monnow Road, London, SE1 5RQ

A newly refurbished, one bedroom Victorian apartment, located in the heart of Bermondsey. The apartment boasts a naturally bright reception room, a modern kitchen with plenty of storage, a sleek bathroom and a double bedroom. Also featuring a spacious private garden, ideal for alfresco dining and entertaining. Additional storage can be found in the hallway. Residents car parking permits available. The surrounding area features many local amenities such as bars, restaurants, supermarket, the local Bermondsey blue market, convenience store and cafes. The property also has good transport links and is only a walk away from the greenery of Southwark Park.

180 Years Left On the Lease
Service Charge: £645 per year
Ground Rent: £10 per year
Council Tax Band B

Council tax and, where applicable, lease information, service charges and ground rent, size are given as a guide only and should always be checked and confirmed by your Solicitor prior to exchange of contracts. Please note the balcony is accessible by this property only however it is not part of the lease. Please note some pics have been virtually staged

- Newly Refurbished
- Private Garden
- Period Features
- Chain Free
- Long Lease
- Hard Wooden Flooring
- Excellent Location
- Residents Car Parking Permit Available

Alex & Matteo
ESTATE AGENTS

Offers in excess of £400,000

Monnow Road, London, SE1

Approximate Area = 486 sq ft / 45.1 sq m

For identification only - Not to scale

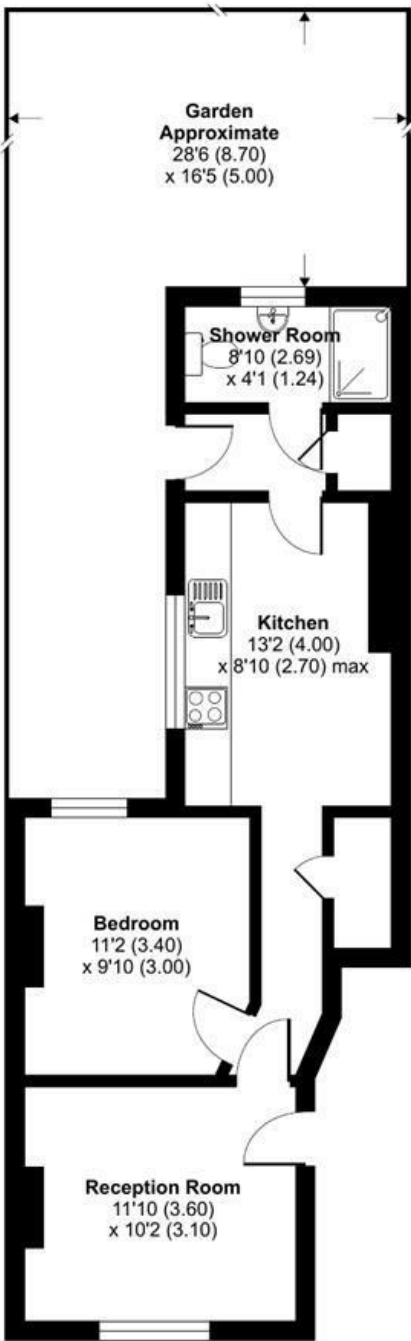

GROUND FLOOR

Alex & Matteo
ESTATE AGENTS



Floor plan produced in accordance with RICS Property Measurement 2nd Edition, Incorporating International Property Measurement Standards (IPMS2 Residential). © nitchecom 2024. Produced for Alex & Matteo Estate Agents. REF: 1203975

